



Cast steel short body gate valves outside screw and yoke, PN 16



Art. 60

Flanges: UNI EN 1092-2 PN 16

Design: DIN 3352 Face to face length: EN 558-1, serie 14. DIN 3202 F4

Installation: horizontal/ vertical

APPLICATIONS • Water • Steam • Oil and refineries

- Fig. 60A: body/wedge CF8/304

- Fig. 60I: body/wedge CF8M/316

The cast steel short body gate valves outside screw and yoke are used for several installations, usually for industrial plants with dangerous liquids, or high temperature, and they can carry pressure up to 16 bar. This gate valve is flanged PN 16. These gate valves are made in cast steel, with body and wedge seat rings in stainless steel. They come from standard execution by handwheel. Gear operated from DN 600 and up. Body, bonnet and wedge in stainless steel upon request.

Materials

body-bonnet	cast steel GS-C25, GP-240-GH
wedge	cast steel GS-C25, GP-240-GH
handwheel	pressed steel
stem	stainless steel X20 CR13
sealing seats body and wedge	stainless steel
stem packing	graphite
bonnet gasket	graphite
painting	nitro enamel outside

Dimensions

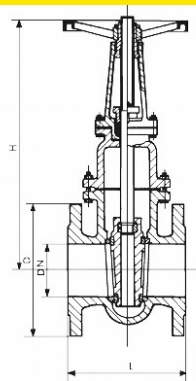

DN	L mm.	H mm.	D mm.	Weight kg.
50	150	315	165	17
65	170	370	185	19
80	180	410	200	21
100	190	450	220	27
125	200	525	250	35
150	210	600	285	56
200	230	760	340	63
250	250	990	405	98
300	270	1010	460	151
350	290	1140	520	186
400	310	1295	580	297
450	330	1380	640	460
500	350	1535	715	540
600	390	2435	840	930
700	430	2925	895	1200
800	470	3275	1015	1800
900	510	3670	1113	2800

Pressure

DN	Nominal pressure	Test pressure Mpa	Max working pressure Mpa
mm	BAR	body	seat
50-600	16	2,4	17,6
700-900	10	1,5	1,1

